



US 20190219647A1

(19) **United States**(12) **Patent Application Publication****Foo et al.**(10) **Pub. No.: US 2019/0219647 A1**(43) **Pub. Date: Jul. 18, 2019**(54) **IMAGE-GUIDED BIOPSY TECHNIQUES****Publication Classification**

(71) Applicants: **General Electric Company**,  
Schenectady, NY (US); **Wisconsin  
Alumni Research Foundation**,  
Madison, WI (US)

(51) **Int. Cl.**  
**G01R 33/28** (2006.01)  
**A61B 8/08** (2006.01)  
(52) **U.S. Cl.**  
CPC ..... **G01R 33/285** (2013.01); **A61B 10/0233**  
(2013.01); **A61B 8/0841** (2013.01)

(72) Inventors: **Thomas Kwok-Fah Foo**, Clifton Park,  
NY (US); **Jhimli Mitra**, Niskayuna,  
NY (US); **Bo Wang**, Schenectady, NY  
(US); **Lowell Scott Smith**, Niskayuna,  
NY (US); **David Martin Mills**,  
Niskayuna, NY (US); **Warren Lee**,  
Niskayuna, NY (US); **James Hartman  
Holmes**, Cross Plains, WI (US); **Bryan  
Bednarz**, Madison, WI (US); **Roberta  
Marie Strigel**, Madison, WI (US)

(57) **ABSTRACT**

A system and method for providing virtual real-time MRI-guidance for a biopsy outside of a conventional MRI scanner is described. MR images and ultrasound images of a region of a patient's body are simultaneously acquired during a pre-biopsy procedure. Respiratory states that the patient may experience during the biopsy are then determined from the acquired ultrasound images, and each respiratory state is associated with corresponding MR images. The MR images are indexed with their corresponding respiratory state. Ultrasound images are then acquired of the patient during a biopsy procedure. The respiratory state of the patient is determined from the ultrasound images, and the corresponding indexed MR images are displayed.

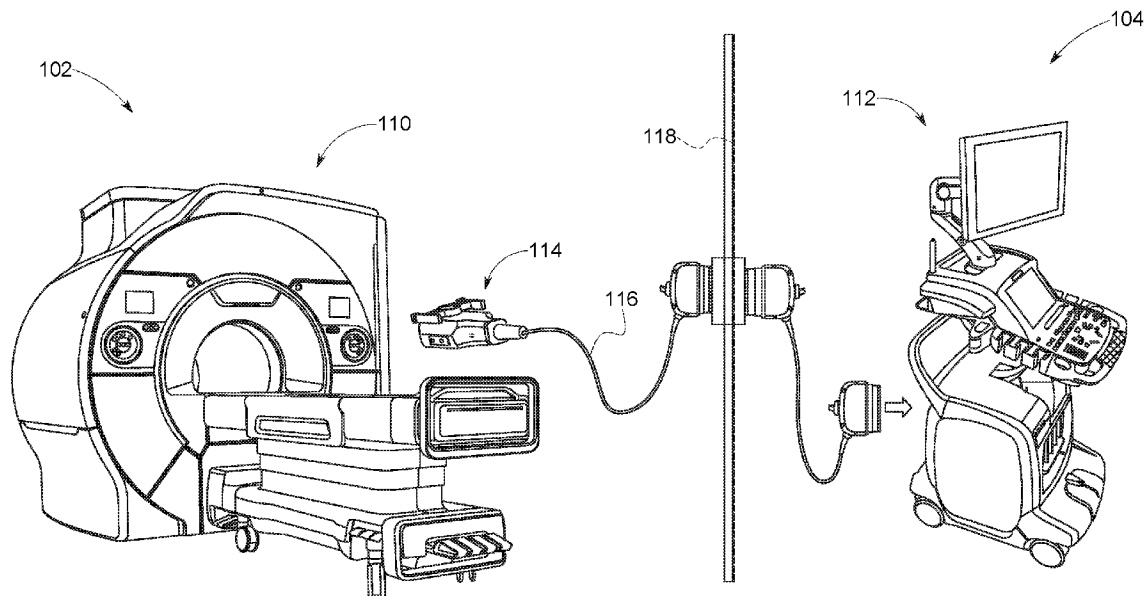
(21) Appl. No.: **15/870,519**(22) Filed: **Jan. 12, 2018**

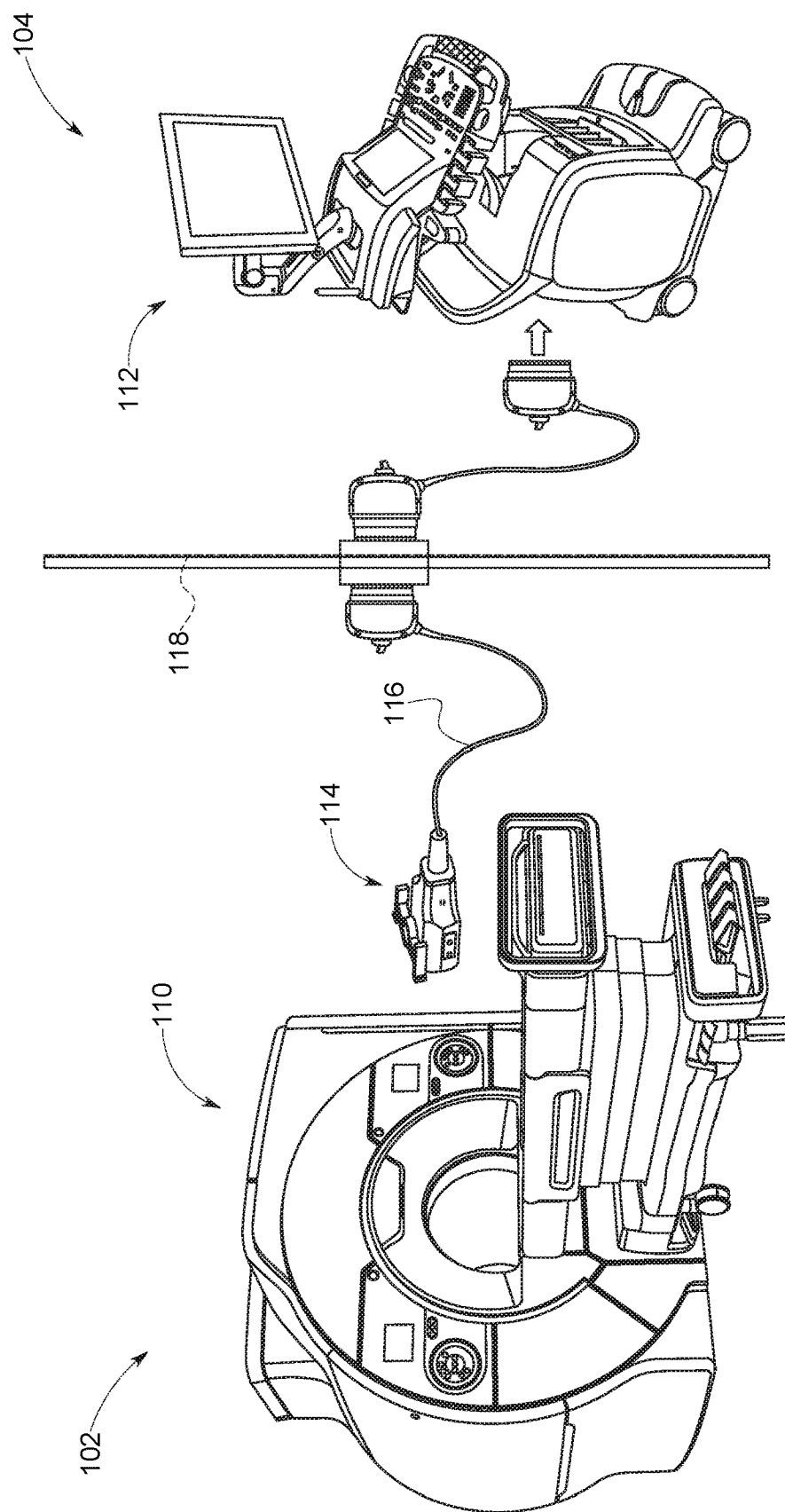

FIG. 1

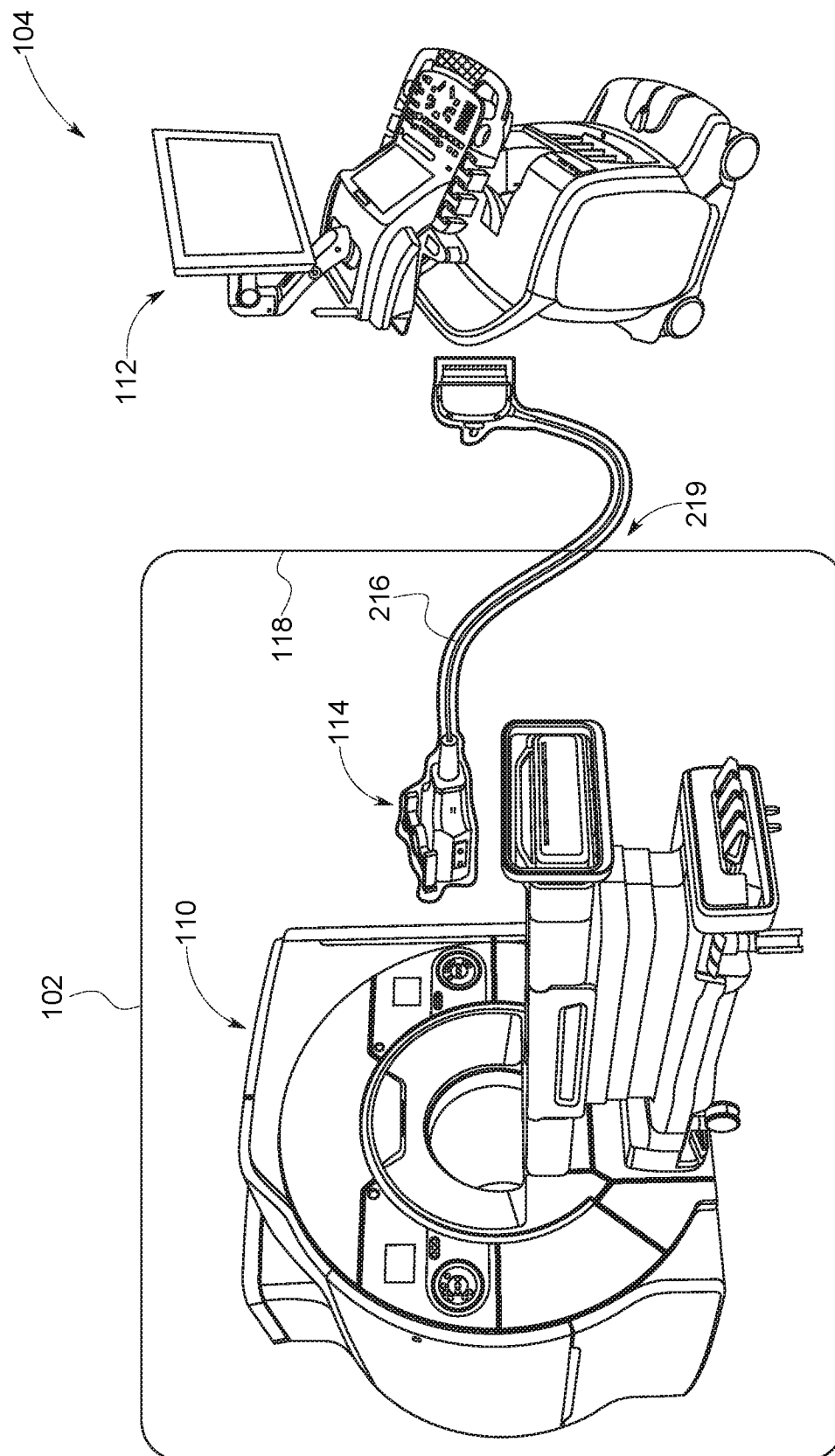

FIG. 2

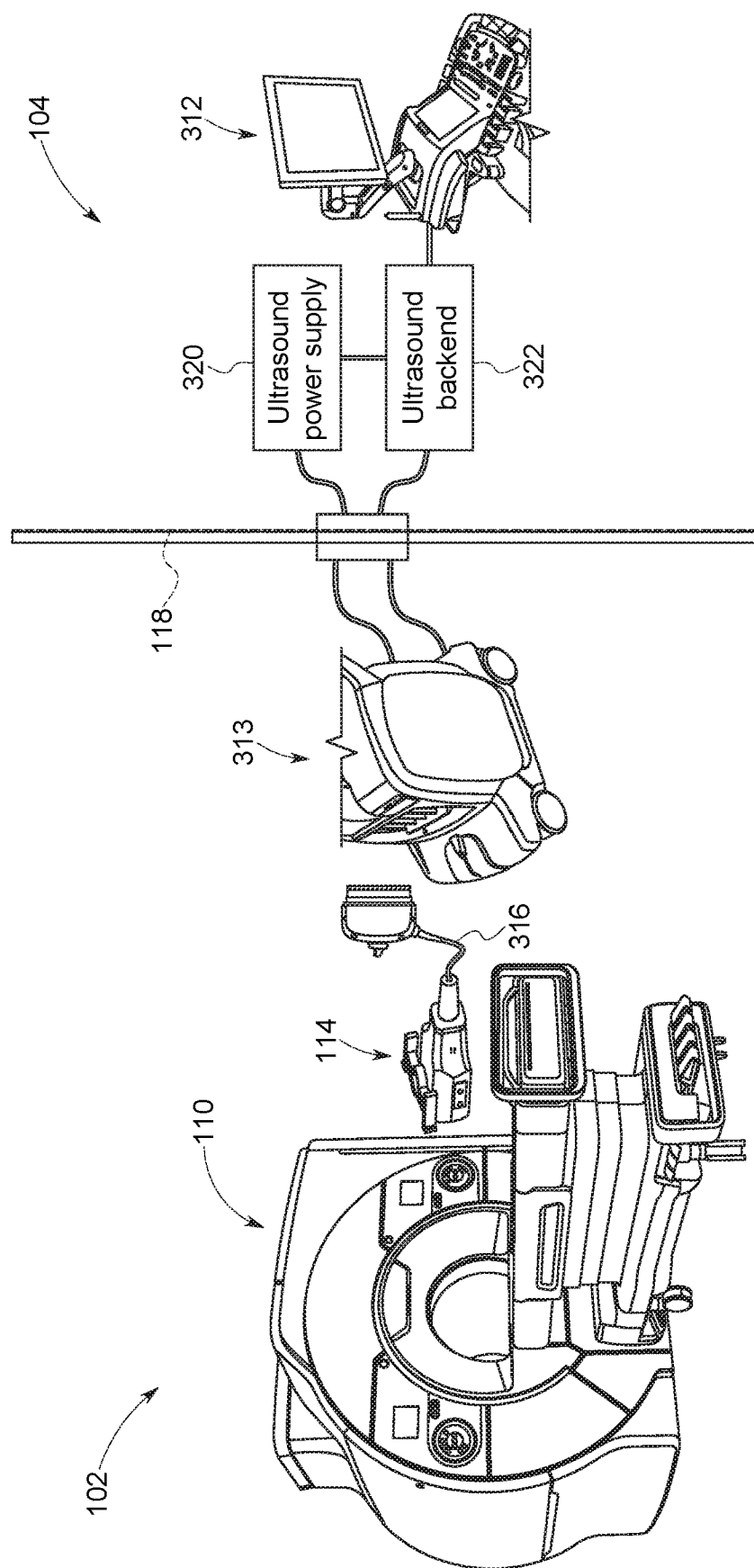

FIG. 3

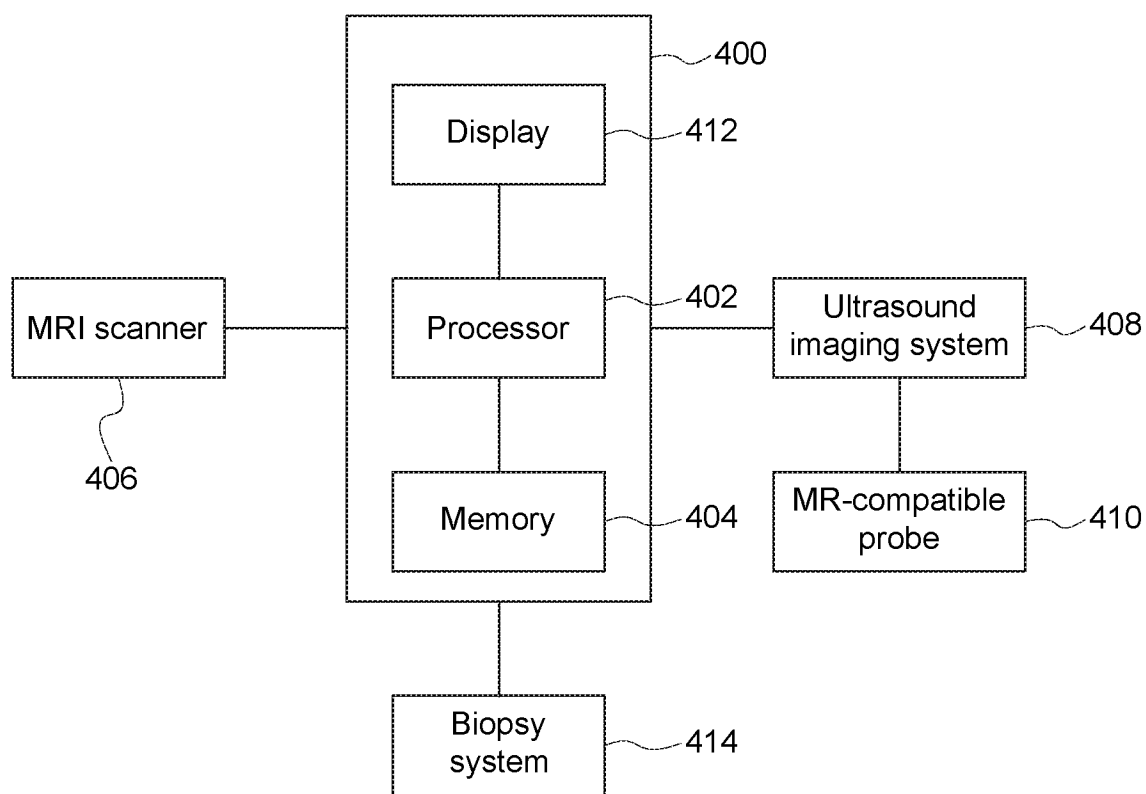

FIG. 4

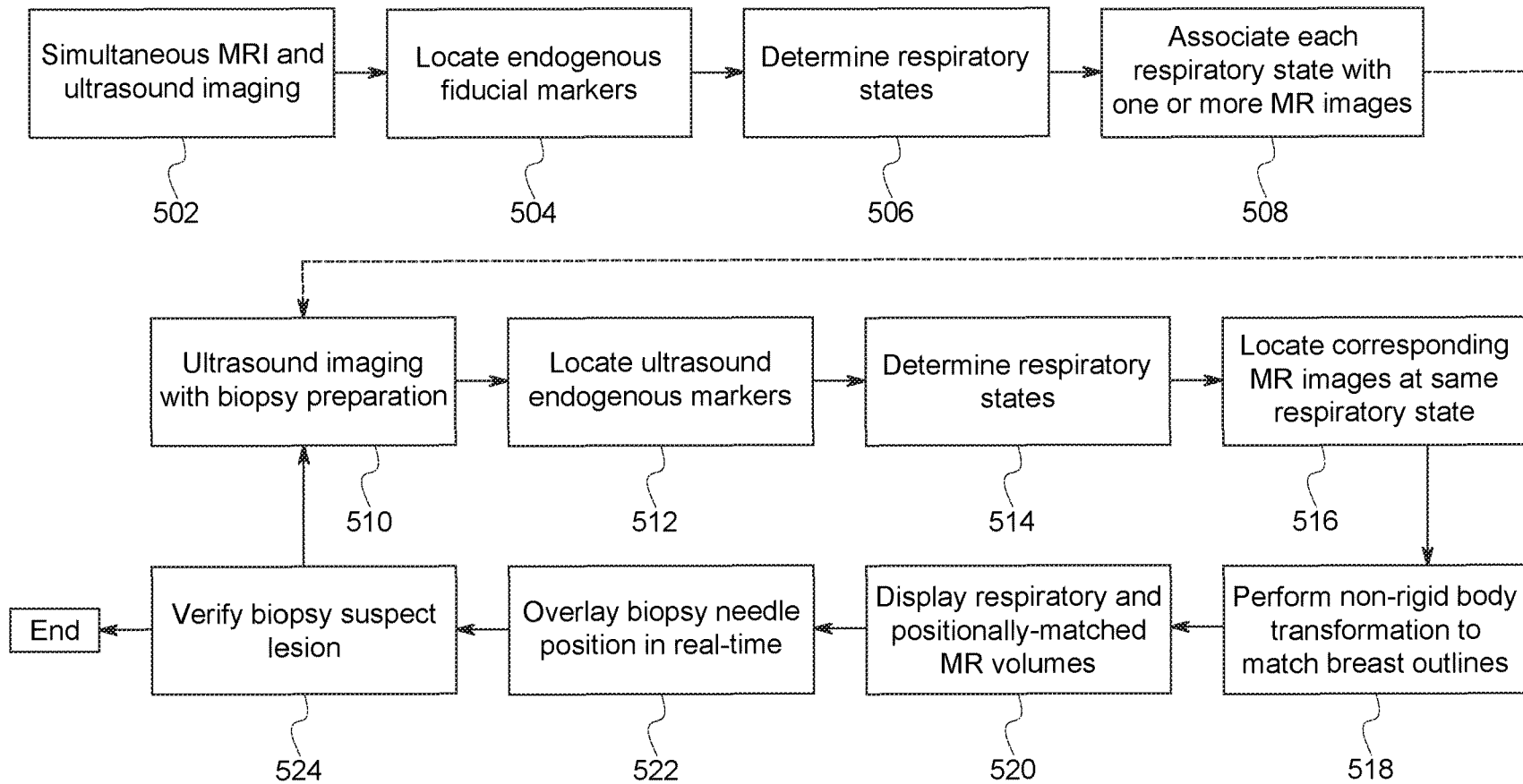

FIG. 5

## IMAGE-GUIDED BIOPSY TECHNIQUES

### STATEMENT REGARDING FEDERALLY SPONSORED RESEARCH & DEVELOPMENT

**[0001]** This invention was made with Government support under contract number R01CA190928 awarded by the National Cancer Institute of the National Institutes of Health. The Government has certain rights in the invention.

### BACKGROUND

**[0002]** The subject matter disclosed herein relates to the use of ultrasound and magnetic resonance imaging modalities, such as for use during image-guided breast biopsies.

**[0003]** An image-guided breast biopsy typically involves using an imaging procedure, such as ultrasound imaging or magnetic resonance imaging (MRI), to guide the biopsy needle to extract tissue at a suspect lesion in a patient's body. Ultrasound imaging provides a high frame rate to follow the trajectory of the needle during the biopsy process. However, conventional ultrasound imaging has a limited field of view, which can lead to misinterpretations in the position of the suspect lesion or the needle. In contrast, MRI provides a higher sensitivity in the detection of lesions. It also delivers three-dimensional positional information and a large field of view. A typical MRI-guided breast biopsy places the patient in the prone position with the breast of the patient immobilized by two compression plates and a grid. The grid is used to locate the suspect lesion and indicate the insertion point of the biopsy needle. Due to limited patient access within the MRI scanner, the patient must be periodically removed from the MRI to reposition the biopsy needle and moved back into the MRI scanner for further imaging. Thus, active visualization of the progression of the biopsy needle or verification of the biopsy site cannot be performed while the patient is outside the MRI scanner. Additionally, breast compression can be very painful for the patient and can contribute to mischaracterization of a lesion type or underestimation of the size of the lesion. Unlike, MRI-guided breast biopsies, ultrasound-guided breast biopsies place the patient in a supine position and do not require breast compression.

### BRIEF DESCRIPTION

**[0004]** Certain embodiments commensurate in scope with the originally claimed subject matter are summarized below. These embodiments are not intended to limit the scope of the claimed subject matter, but rather these embodiments are intended only to provide a brief summary of possible embodiments. Indeed, the invention may encompass a variety of forms that may be similar to or different from the embodiments set forth below.

**[0005]** In one embodiment, a method for providing real-time image guidance for a biopsy includes acquiring magnetic resonance (MR) images and pre-biopsy ultrasound images of an anatomical region of a patient. The MR images and the pre-biopsy ultrasound images are acquired simultaneously over a period of time. The method includes determining respiratory states of the patient from the pre-biopsy ultrasound images. A respiratory state is associated with each of the MR images or each of a set of MR images. The method also includes indexing the MR images with their

corresponding respiratory state and storing the MR images or each of a set of MR images with their corresponding respective respiratory state.

**[0006]** In another embodiment, a method for providing real-time image guidance for a biopsy includes acquiring biopsy ultrasound images of an anatomical region of a patient, and determining a biopsy respiratory state from the biopsy ultrasound images. The biopsy respiratory state is identified as a respiratory state of the patient associated with one or more stored MR images of the patient. The method includes retrieving the stored MR images that correspond to the identified respiratory state, and displaying the stored MR images that correspond to the identified respiratory state.

**[0007]** In another embodiment, an interventional guidance system includes an ultrasound imaging system configured to acquire pre-biopsy ultrasound images and biopsy ultrasound images of an anatomical region of a patient, and a processor. The processor is configured to determine one or more respiratory states of the patient from the acquired pre-biopsy ultrasound images, associate the one or more respiratory states with each MR image, index the MR images with their associated respiratory states, and determine a biopsy respiratory state from the biopsy ultrasound images. The biopsy respiratory state is identified as corresponding to one of the respiratory states determined from the pre-biopsy ultrasound images. This in turn determines the MR images or the set of MR images acquired from the pre-biopsy scan that correspond to the current respiratory state. Thus, an accurate representation of the location of the anatomical structure at that point in time can be presented or displayed to guide the biopsy procedure, specifically the biopsy needle trajectory to the biopsy target. The processor is also configured to display the MR images that correspond to the identified respiratory state.

### BRIEF DESCRIPTION OF THE DRAWINGS

**[0008]** These and other features, aspects, and advantages of the present invention will become better understood when the following detailed description is read with reference to the accompanying drawings in which like characters represent like parts throughout the drawings, wherein:

**[0009]** FIG. 1 illustrates an embodiment of a combined magnetic resonance and ultrasound imaging system with a MR-compatible, real-time, three-dimensional imaging ultrasound probe, in accordance with aspects of the present disclosure;

**[0010]** FIG. 2 illustrates an embodiment of an alternative combined magnetic resonance and ultrasound imaging system with a MR-compatible ultrasound probe having a single, continuous shield cable that plugs into the ultrasound system, in accordance with aspects of the present disclosure;

**[0011]** FIG. 3 illustrates an embodiment of an alternative combined magnetic resonance and split ultrasound imaging system arrangement, in accordance with aspects of the present disclosure;

**[0012]** FIG. 4 illustrates an embodiment of an interventional guidance system, in accordance with aspects of the present disclosure; and

**[0013]** FIG. 5 illustrates a flowchart for an embodiment of a combined magnetic resonance and ultrasound image-guided biopsy, in accordance with aspects of the present disclosure.

## DETAILED DESCRIPTION

**[0014]** One or more specific embodiments will be described below. In an effort to provide a concise description of these embodiments, all features of an actual implementation may not be described in the specification. It should be appreciated that in the development of any such actual implementation, as in any engineering or design project, numerous implementation-specific decisions must be made to achieve the developers' specific goals, such as compliance with system-related and business-related constraints, which may vary from one implementation to another. Moreover, it should be appreciated that such a development effort might be complex and time consuming, but would nevertheless be a routine undertaking of design, fabrication, and manufacture for those of ordinary skill having the benefit of this disclosure.

**[0015]** When introducing elements of various embodiments of the present invention, the articles "a," "an," "the," and "said" are intended to mean that there are one or more of the elements. The terms "comprising," "including," and "having" are intended to be inclusive and mean that there may be additional elements other than the listed elements. Furthermore, any numerical examples in the following discussion are intended to be non-limiting, and thus additional numerical values, ranges, and percentages are within the scope of the disclosed embodiments.

**[0016]** As used herein, the term "virtual real-time magnetic resonance image(s)" refers to the display of previously acquired MR images that correspond to a current respiratory state of a patient (as further explained below). Thus, displaying these MR images provides "real-time" MR imaging of the patient even though the current image modality being employed is ultrasound. By displaying the correct previously acquired MR images or set of MR images that accurately represents the positions of the anatomical structures within the imaging field-of-view, a system and process is described that enables "real-time" MR imaging when another imaging modality, such as ultrasound, is employed.

**[0017]** The present approach relates to using virtual real-time magnetic resonance images for direct imaging guidance of a biopsy procedure. In certain implementations discussed herein, the imaging and biopsy procedures are performed on a patient's breast without breast compression or the use of plates to guide the biopsy needle. Although certain aspects of the present disclosure focus on imaging guidance of breast biopsy procedures, a person of ordinary skill in the art should recognize that the present approach can be applied to other suitable regions of a person's body. The image-guided biopsy procedure combines MR imaging with real-time ultrasound imaging to provide guidance for a biopsy needle. During the pre-biopsy stage of a breast biopsy procedure, an ultrasound probe acquires ultrasound images of the breast of a patient simultaneously with the acquisition of MR images in a MR scanner. The ultrasound probe is MR-compatible such that it is able to operate simultaneously in an MR scanner while the MR scanner is in operation. The ultrasound images provide a measure of the patient's respiratory state. Concurrently acquired MR images are then indexed (e.g., stored in a table) with the determined respiratory state of the patient such that each respiratory state determined from the ultrasound images has a corresponding MR image. The ultrasound images also help determine a mathematical transformation function that can be used to deform the acquired MR images to represent the real-time spatial dis-

position of the breast of the patient in a subsequent biopsy procedure. During the biopsy stage of the breast biopsy procedure, the ultrasound probe acquires ultrasound images of the breast of the patient in real time. The ultrasound images are used to identify the current respiratory state of the patient. A processor then accesses the stored, pre-acquired MR images from the pre-biopsy stage that are associated with different respiratory states. The processor then identifies the respiratory state which may be represented by one or more identifiers from a set of identifiers. The identifiers may consist of a set of one or more numbers or parameters that are linked to a unique respiratory state. The processor then searches for the corresponding indexed pre-biopsy MR images or set of images that match the current respiratory state, and the images are displayed to guide the biopsy needle.

**[0018]** FIG. 1 shows a possible configuration of the MRI system 110 and ultrasound system 112 suitable for concurrent image acquisition. An MR-compatible probe 114 for use with the MRI system 110 is connected to the ultrasound system 112 in a separate ultrasound control room 104 via a probe cable 116 that passes through the shielded wall 118 of the MRI room 102. The probe cable 116 does not significantly degrade the image quality of the ultrasound system 112 due to the presence of transmitters and low noise amplifiers in the probe handle. The probe components are chosen to have very low or no ferromagnetic material content for MR compatibility. Additionally, the probe 114 is designed to minimize loops in electronic circuitry to avoid induced currents in the changing magnetic field. The entirety of the probe 114, including the transducer face, housing, and cable 116, is enclosed in a full electromagnetic interference (EMI) shield to prevent unwanted ultrasound-MRI interference. The transducer face may be covered, for example, by a 10 to 15 micron thick aluminum foil, to electrically shield the transducer while having a negligible impact on acoustic performance.

**[0019]** In another possible configuration of the MRI system 110 and ultrasound system 112, the MR-compatible probe 114 may be hands-free and electronically steerable. The probe 114 may be operated remotely from the control room 104 of the ultrasound system 112 or at another suitable location. The probe 114 also may be fixed to the breast of the patient via Velcro straps, in a rigid breast-constraining structure that allows biopsy needle access, or another suitable means to allow for simultaneous MR and ultrasound imaging.

**[0020]** FIG. 2 illustrates another possible configuration of the MRI system 110 and ultrasound system 112. The MR-compatible probe 114 is attached to a single, continuous, shielded probe cable 216, which penetrates the wall separating the MR room 102 from the control room 104 or at another suitable location. The shielded probe cable 216 plugs into the ultrasound system 112 in the control room 104. The electrical shield of the shielded probe cable 216 may be connected to a shielded wall 118 of the MR room 102 at the penetration location 219 in order to provide full EMI shielding to reduce unwanted ultrasound-MRI interference.

**[0021]** FIG. 3 shows an alternative split ultrasound system arrangement suitable for concurrent MR and ultrasound image acquisition. The ultrasound system is split into an MR-compatible front end 313 which is placed in the MR room 102, and a power supply 320 and ultrasound backend



**322** which are placed in the ultrasound control room **104**. Power supply **320** and ultrasound backend **322** may be separate components or housed together in a single unit **312**. Power and digital communication lines pass through the shielded wall **118** between the front end **313** and the power supply **320** and backend **322**. The advantage of this system arrangement is that since the ultrasound system has a MR-compatible front end **313**, a shorter probe cable **316** (e.g., two meters to three meters) would be sufficient to connect the probe to the front end. For probes that do not have transmitters and low-noise amplifiers integrated in the probe handle, reducing the cable length reduces parasitic load and thus improves image quality.

**[0022]** FIG. 4 shows a high-level view of components of an interventional guidance system **400** that may be suitable in the implementation of the present approach. In particular, the present approach may be implemented as one or more executable routines stored on memory **404** or data storage components of the processor **402** of the interventional guidance system **400**. The illustrated interventional guidance system **400** communicates with an MRI scanner **406** configured to acquire MR images of a patient during a pre-biopsy stage. The MRI scanner may be at any field strength. The interventional guidance system **400** also communicates with an ultrasound imaging system **408** configured to acquire ultrasound images of the patient with an MR-compatible probe **410** during the pre-biopsy stage and during a biopsy procedure. The processor **402** may be a component of a picture archival system, a dedicated navigational system (as shown in FIG. 4), or part of the ultrasound imaging system **408** where the ultrasound system **408** functions as or otherwise provides navigation functionality. The processor **402** may store the acquired images from the MRI scanner, the ultrasound imaging system, or both. The interventional guidance system **400** may also communicate with a biopsy system **414** to provide guidance during a biopsy procedure. We note that the system and process described entails two stages in the biopsy procedure, a pre-biopsy stage where simultaneous MR and ultrasound imaging occurs, and an actual biopsy stage or procedure where ultrasound imaging and needle insertion occurs.

**[0023]** FIG. 5 illustrates a flowchart of a method of providing virtual real-time magnetic resonance images for direct imaging guidance of a breast biopsy of a patient, such as a patient in the supine position. The method consists of two stages of imaging: (1) a pre-biopsy stage (i.e., steps **502** to **508**); and (2) a biopsy stage (steps **510** to **524**). The steps of the pre-biopsy stage may occur at any time before the biopsy stage and may occur at a different location or the same location. For example, the pre-biopsy stage may be conducted in the MR scanner and the biopsy procedure may be performed outside the MR scanner, such as in a standard clinical examination room.

**[0024]** During the pre-biopsy stage, in step **502**, three-dimensional MR images and real-three-dimensional (four-dimensional) ultrasound images of a patient's breast are acquired simultaneously in time. The MR images and each ultrasound images do not have to be completely aligned in time. If the images are not temporally aligned, techniques, such as temporal interpolation, may be used to substantially align or substantially link the images. The MR images may be acquired without breast compression or with limited compression or positioning. For example, in one embodiment, the MR system uses a soft, conformable, multi-

element, lightweight coil during acquisition of the MR images. In step **504**, one or more endogenous fiducial markers are identified in the ultrasound images at each time frame. For example, the endogenous fiducial markers may include blood vessels, the structural anatomy of the breast (e.g., the chest wall), or the suspect lesion itself.

**[0025]** In step **506**, respiratory states at each time frame of the ultrasound images are determined using positional or shape changes in the ultrasound images of the identified endogenous fiducial marker of step **504**. The respiratory states represent the possible respiratory states the patient may experience during the biopsy procedure, for both the pre-biopsy and biopsy stages. For example, the respiratory states may include inhalation, exhalation, short-breath holds, irregular breaths, or any sub-state of a respiratory state. In step **508**, each determined respiratory state or sub-state is then associated with one or more acquired MR images. A table or index of the determined respiratory states with their corresponding MR images is created.

**[0026]** During the biopsy stage, the ultrasound probe may be similar or identical to the ultrasound probe used to acquire ultrasound images during the pre-biopsy stage. In one embodiment, the ultrasound probe may be manually manipulated in the biopsy stage. Manual manipulation of the ultrasound probe would provide a more optimal visualization of the biopsy target and the biopsy needle in the same image. In another embodiment, the ultrasound probe may be electronically steered or remotely operated during the pre-biopsy stage and the biopsy stage, electronically steered during the pre-biopsy stage and manually manipulated in the biopsy stage, or manually manipulated during both the pre-biopsy stage and the biopsy stage.

**[0027]** In step **510**, three-dimensional ultrasound images of the patient's breast are acquired in real-time. In step **512**, the four-dimensional ultrasound images are used to locate the same endogenous fiducial markers identified in step **504**. In step **514**, the patient's current respiratory state is determined using the positional or spatial information of the endogenous fiducial markers in the ultrasound images. In step **516**, the index or table of the previously determined respiratory states and their corresponding MR images is accessed, and the MR images associated with the patient's current respiratory state are retrieved. In step **518**, a non-rigid body transformation is performed on the retrieved MR images of step **516**. The non-rigid body transformation matches the positional state of the patient's breast during the pre-biopsy stage of the procedure with the current positional state of the patient's breast. For example, the breast outlines or the endogenous fiducial markers in the MR images and the ultrasound images are matched. Thus, the MR images are deformed to fit the ultrasound images.

**[0028]** This transformation of the MR images provides an accurate representation of the shape and position of the patient's breast during the biopsy procedure. The non-rigid body transformation of the MR images may be conducted at any time prior to the insertion of the biopsy needle into the patient for each set of MR images corresponding to the determined respiratory states during the pre-biopsy stage of the procedure. This provides an accurate map of the position of the patient's breast and tissues within the patient's breast (e.g., the suspect lesion, arteries, veins, fat layers, and muscle layers). If the position of the patient's breast changes during the biopsy procedure (e.g., during needle insertion), the non-rigid body transformation may be reapplied to each

set of MR images to provide accurate, updated images with minimal computational overhead.

**[0029]** The respiratory state matching steps **512** to **516** and the deformable registration step **518** may be represented by a single mathematical transfer function or separate mathematical transformation functions. For example, the mathematical transformation functions may represent a mapping of one respiratory state to another, one positional state of a deformable anatomical structure (e.g., the breast) to another positional state, or a combination of both. A person of ordinary skill in the art should recognize that the mathematical transformation function may be any suitable geometric operation utilized with the observed anatomical markers in the ultrasound and MR images.

**[0030]** In step **520**, the transformed MR images may be displayed to provide an accurate, real-time representation of the position of the suspect lesion and the surrounding anatomical details of the breast to guide the biopsy needle. However, a signal, such as a red dot, may be displayed if no MR image is available that corresponds to the current respiratory state of the patient.

**[0031]** In step **522**, the position of the biopsy needle may be derived from the real-time ultrasound images or the external positional markers on the biopsy needle holder. For example, the external positional markers may include infrared sensors, magnetoresistance sensors, or other suitable means. The position of the biopsy needle may then be overlaid onto the displayed MR images. To ensure accuracy of the overlay, the MR image frame-of-reference and the biopsy needle frame of reference may be calibrated. For example, infrared sensors on the biopsy needle may be used to identify the position of the biopsy needle tip and the orientation and trajectory of the biopsy needle. Simple calibration of the position and angle of the biopsy needle tip is performed to align and register the MR image frame-of-reference to the biopsy needle frame of reference.

**[0032]** In step **524**, the completion of the biopsy is determined. If the biopsy of the suspect lesion is determined to have been successfully completed, the procedure terminates. However, if the biopsy is determined to be incomplete, the imaging and guidance procedure may continue to be performed until the biopsy of the suspect lesion is determined to have been successfully completed.

**[0033]** While the embodiments described hereinabove perform the procedure with the patient in the supine position, a person skilled in the art should recognize that the procedure is not limited as such by the patient's position. The procedure may be performed on the patient in the prone position. For example, the procedure may require the use of a supporting structure to allow the breast of the patient to be suspended while the patient is in the prone position. Additionally, a corresponding MRI receiver coil customized for the breast may be necessary.

**[0034]** Technical effects of the disclosure include providing virtual real-time MRI-guidance for a breast biopsy outside of a conventional MRI scanner. This allows for active visualization of the biopsy needle progression or verification of the biopsy site of the patient outside of the MRI scanner. The biopsy and imaging procedure permits the patient to be in the more comfortable supine position instead of the prone position. Additionally, the procedure may be performed without the need for breast compression or the use of plates to guide the biopsy needle.

**[0035]** This written description uses examples, including the best mode, to enable any person skilled in the art to practice the invention, including making and using any devices or systems and performing any incorporated methods. The patentable scope is defined by the claims, and may include other examples that occur to those skilled in the art. Such other examples are intended to be within the scope of the claims if they have structural elements that do not differ from the literal language of the claims, or if they include equivalent structural elements with insubstantial differences from the literal language of the claims.

**1.** A method for providing real-time image guidance for a biopsy, comprising:

- acquiring a plurality of MR images of an anatomical region of a patient;
- acquiring a plurality of pre-biopsy ultrasound images of the anatomical region, wherein the MR images and the pre-biopsy ultrasound images are acquired simultaneously over a scanned duration;
- determining a plurality of respiratory states of the patient from the pre-biopsy ultrasound images, wherein a respective respiratory state is associated with one or more MR images;
- indexing the MR images with their corresponding respective respiratory state; and
- storing the MR images with their corresponding respective respiratory state.

**2.** The method of claim **1**, comprising identifying an endogenous fiducial marker in the pre-biopsy ultrasound images.

**3.** The method of claim **2**, wherein determining the plurality of respiratory states of the patient from the pre-biopsy ultrasound images is based on a positional change or change in shape of the anatomical region with respect to the identified endogenous fiducial marker.

**4.** The method of claim **1**, wherein the anatomical region of the patient includes a breast of the patient.

**5.** The method of claim **4**, wherein the MR images and the pre-biopsy ultrasound images are acquired without breast compression.

**6.** The method of claim **1**, wherein the plurality of respiratory states includes exhalation, inhalation, short-breath holds, or irregular breaths.

**7.** The method of claim **1**, wherein the respective respiratory state is associated with one or more MR images by substantially linking the MR images with the pre-biopsy ultrasound images in time over the scanned duration.

**8.** The method of claim **1**, wherein the patient is in a supine position.

**9.** A method for providing real-time image guidance for a biopsy, comprising:

- acquiring a plurality of biopsy ultrasound images of an anatomical region of a patient;
- determining a biopsy respiratory state from the biopsy ultrasound images, wherein the biopsy respiratory state is identified as a respiratory state of the patient associated with one or more stored MR images of the patient;
- retrieving the stored MR images that correspond to the identified respiratory state; and
- displaying the stored MR images that correspond to the identified respiratory state.

**10.** The method of claim **9**, comprising deforming the stored MR images to substantially match the structure of the anatomical region of the patient during the identified biopsy respiratory state.

**11.** The method of claim **9**, comprising displaying a position of a biopsy needle on the displayed MR images.

**12.** The method of claim **11**, wherein the position of the biopsy needle is displayed by identifying a position or an orientation of the biopsy needle using infrared sensors or magnetoresistance sensors.

**13.** An interventional guidance system, comprising:

an ultrasound imaging system configured to acquire pre-biopsy ultrasound images and biopsy ultrasound images of an anatomical region of the patient; and a processor configured to:

determine one or more respiratory states of the patient from the pre-biopsy ultrasound images;

associate the one or more respiratory states with one or more MR images;

index the MR images with their corresponding respiratory states;

determine a biopsy respiratory state from the biopsy ultrasound images, wherein the biopsy respiratory state is identified as one of the respiratory states associated with the one or more MR images; and

display the MR images that correspond to the identified respiratory state.

**14.** The interventional guidance system of claim **13**, wherein the interventional guidance system is in communi-

cation with an MRI scanner configured to acquire the one or more MR images of the anatomical region of the patient.

**15.** The interventional guidance system of claim **13**, comprising a biopsy needle sensor, wherein the processor is configured to display a position of the biopsy needle on the displayed MR images.

**16.** The interventional guidance system of claim **13**, wherein the biopsy needle includes infrared sensors or magnetoresistance sensors for tracking a position or an orientation of the biopsy needle.

**17.** The interventional guidance system of claim **13**, wherein the anatomical region of the patient includes a breast of the patient and the MR images, the pre-biopsy ultrasound images, and the biopsy ultrasound images are acquired without breast compression.

**18.** The interventional guidance system of claim **13**, wherein the ultrasound imaging system includes an MR-compatible ultrasound probe.

**19.** The interventional guidance system of claim **13**, wherein the processor is configured to deform the MR images to fit the structure of the anatomical region of the patient during the identified biopsy respiratory state.

**20.** The interventional guidance system of claim **13**, wherein the processor is configured to identify an endogenous fiducial marker from the pre-biopsy ultrasound images and biopsy ultrasound images.

\* \* \* \* \*